

CONSULATE GENERAL OF FRANCE IN NEW YORK

934 FIFTH AVENUE, NEW YORK, NY 10021





Facing Central Park, at number 934 on mythic Fifth Avenue, the heavily influenced by the Italian Renaissance façade of the Consulate General of France rises up. This historic manor is the work of architects Alexander Walter and Léon Gillette, who conceived this five-story residence in 1926 for the rich financier, Charles E. Mitchell. Its grandiose style was inspired by the early 20th century Decorative Arts.

Inside, a large spiral staircase composed of a *trompe-l'oeil* marble leads the guests all the way to the second floor, the *piano nobile*. The staircase leads to the **Salon Cheminée**, whose high ceiling gives it volume. This room is also inspired by the Renaissance, featuring a polychrome marble floor, smooth-shafted columns in *trompe l'oeil* veined marble and pilasters topped with Corinthian-style capital.

The Salon Cheminée opens to the left onto the **Salon Chapelle**, with its magnificent arched ceiling and its parquet *à la française*. It owes its name to its complex vaulting and polygonal shape, which recall the *chevet* of a church. On the wall, *Verdure*, a large-scale 18th century tapestry from Brussels, conveys a forest mood in tones of dark green.

On the other side, the **Salon Rose** is lit by three wide French windows with round arches offering a stunning view of Central Park and its greenery. The natural lighting is amplified by a splendid Louis XV bronze and crystal Baccarat chandelier with fifty-six lights. A remarkable polychrome-coffered wooden ceiling covers the entire room, representing various ancient Greco-Roman mythological figures such as nymphs, goddesses and centaurs. The Salon Rose contains some of the most prestigious artwork at the Consulate, including a sumptuous Gobelins tapestry from the 18th century.

The reception salons at the Consulate may host up to 250 guests. Their proportions, lighting and exquisite décor make it the ideal reception area. Our reception areas are ideal for breakfasts, lunch, cocktails, conferences, Gala dinners, fashion shows or product-line launching. The Consulate provides its own in-style furniture adapted to our salons. Our *Maître d'* will accompany you at every moment, constantly caring for your comfort and that of your guests.

“ A curved staircase swept up the guests to the huge living room with its heavy Italian furnishings and red damask curtains on the Park-facing windows. [...] Many a dinner would be followed by a musical performance in the pretty music room which was done in Louis Seize with a white marble fireplace and had curtains of yellow taffeta.”

Craig Mitchell,
“I remember Fifth”, *Town & Country*, September 1989.





Salon Rose

Dimensions: 40 ft long x 26.6 ft wide

Height: 16.4 ft

Surface: 1065.6 ft

Salon Chapelle

Dimensions: 32.2 ft long x 18.4 ft wide

Height: 16.4 ft

Surface: 592 ft



Salon Cheminée

Dimensions: 25 ft long x 14.8 ft wide

Height: 16.4 ft

Surface: 366 ft

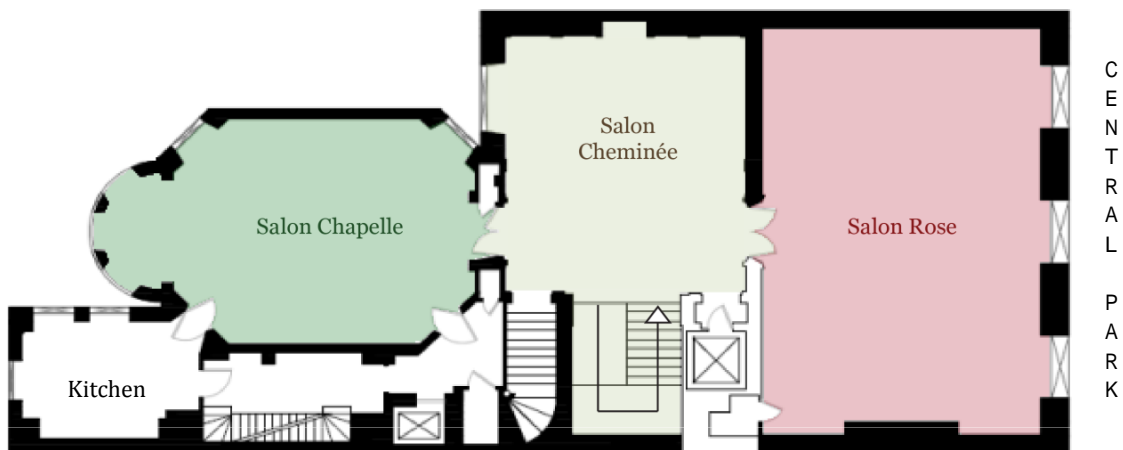

Official website
<http://www.consulfrance-newyork.org/>

Flickr Album
<https://www.flickr.com/photos/consulfrancenyc/>

For more information, you may contact Fanny Pradier: fanny.pradier@diplomatie.gouv.fr